

# ANCHOR SHACKLES

## SCREW PIN

**Material:** Forged 1030 Carbon Steel  
**Finish:** Self-Colored, Hot Galvanized



Screw pin anchor shackles meet Federal Specification RR-C-271D, Type IVA Class 2, Grade A

Self-Colored Stock No.	Galvanized Stock No.	Nominal Shackles Size	Inside Length A	Inside Width		Diameter Pin D	Approx. Wt. Per 100 Pcs.	Rated Capacity Load Lbs.
				At Pin B	At Bow C			
SHS003200-0001	SHS003210-0001	3/16	7/8	3/8	11/16	1/4	6.5	667
SHS004200-0001	SHS004210-0001	1/4	1 1/8	1/2	25/32	5/16	11.5	1,000
SHS005200-0001	SHS005210-0001	5/16	1 7/32	17/32	27/32	3/8	18.4	1,500
SHS006200-0001	SHS006210-0001	3/8	1 7/16	21/32	1 1/32	7/16	31.5	2,000
SHS007200-0001	SHS007210-0001	7/16	1 11/16	23/32	1 5/32	1/2	44.6	3,000
SHS008200-0001	SHS008210-0001	1/2	1 7/8	13/16	1 5/16	5/8	74.5	4,000
SHS010200-0001	SHS010210-0001	5/8	2 3/8	1 1/16	1 11/16	3/4	136.4	6,500
SHS012200-0001	SHS012210-0001	3/4	2 13/16	1 1/4	2	7/8	213.5	9,500
SHS014200-0001	SHS014210-0001	7/8	3 5/16	1 7/16	2 9/32	1	345.5	13,000
SHS100200-0001	SHS100210-0001	1	3 3/4	1 11/16	2 11/16	1 1/8	500.0	17,000
SHS102200-0001	SHS102210-0001	1-1/8	4 1/4	1 13/16	2 29/32	1 1/4	709.0	19,000
SHS104200-0001	SHS104210-0001	1-1/4	4 11/16	2 1/32	3 1/4	1 3/8	991.0	24,000
SHS106200-0001	SHS106210-0001	1-3/8	5 3/16	2 1/4	3 1/2	1 1/2	1328.0	27,000
SHS108200-0001	SHS108210-0001	1-1/2	5 3/4	2 3/8	3 7/8	1 5/8	1690.0	34,000

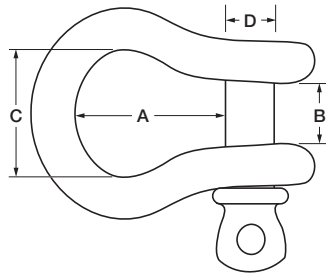

# ANCHOR SHACKLES

## ROUND PIN

**Material:** Forged 1030 Carbon Steel  
**Finish:** Self-Colored, Hot Galvanized



Round pin anchor shackles meet Federal Specification RR-C-271D, Type IVA Class 1, Grade A

Self-Colored Stock No.	Galvanized Stock No.	Nominal Shackles Size	Inside Length A	Inside Width		Diameter Pin D	Approx. Wt. Per 100 Pcs.	Rated Capacity Load Lbs.
				At Pin B	At Bow C			
SHR004200-0001	SHR004210-0001	1/4	1 1/8	1/2	25/32	5/16	11.5	1,000
SHR005200-0001	SHR005210-0001	5/16	1 7/32	17/32	27/32	3/8	18.4	1,500
SHR006200-0001	SHR006210-0001	3/8	1 7/16	21/32	1 1/32	7/16	31.5	2,000
SHR005200-0001	SHR005210-0001	1/2	1 7/8	13/16	1 5/16	5/8	74.5	4,000
SHR010200-0001	SHR010210-0001	5/8	2 3/8	1 1/16	1 11/16	3/4	136.4	6,500
SHR005200-0001	SHR005210-0001	3/4	2 13/16	1 1/4	2	7/8	213.5	9,500

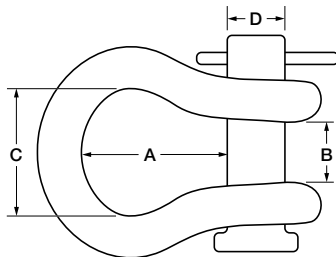

# ANCHOR SHACKLES

## SAFETY BOLT

**Material:** Forged 1030 Carbon Steel

**Finish:** Self-Colored, Hot Galvanized



Self-Colored Stock No.	Galvanized Stock No.	Nominal Shackle Size	Inside Length A	Inside Width		Diameter Pin D	Cotter Pin	Weight
				At Pin B	At Bow C			
SHA005300-0001	SHA005310-0001	5/16	1-3/16	1/2	13/16	3/8	1/16	0.23
SHA006300-0001	SHA006310-0001	3/8	1-3/8	5/8	1	7/16	1/8	0.34
SHA007300-0001	SHA007310-0001	7/16	1-5/8	3/4	1-3/16	1/2	1/8	0.51
SHA008300-0001	SHA008310-0001	1/2	1-7/8	13/16	1-1/4	5/8	1/8	0.81
SHA010300-0001	SHA010310-0001	5/8	2-5/16	1-1/16	1-5/8	3/4	1/8	1.63
SHA012300-0001	SHA012310-0001	3/4	2-3/4	1-3/16	1-15/16	7/8	3/16	2.62
SHA014300-0001	SHA014310-0001	7/8	3-1/4	1-7/16	2-3/16	1	3/16	4.20
SHA100300-0001	SHA100310-0001	1	3-7/8	1-5/8	2-9/16	1-1/8	3/16	5.75
SHA102300-0001	SHA102310-0001	1-1/8	4-1/4	1-11/16	2-11/16	1-1/4	1/4	8.07
SHA104300-0001	SHA104310-0001	1-1/4	4-1/2	2-1/16	3-1/8	1-3/8	1/4	10.74
SHA106300-0001	SHA106310-0001	1-3/8	5-1/8	2-3/16	3-1/2	1-1/2	1/4	15.21
SHA108300-0001	SHA108310-0001	1-1/2	5-3/4	2-1/4	3-3/4	1-5/8	1/4	18.17

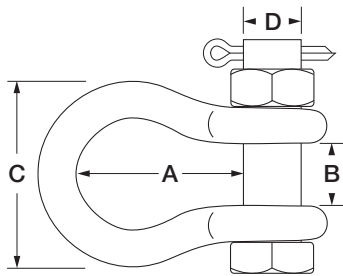

# CHAIN SHACKLES

## SAFETY BOLT

**Material:** Forged 1030 Carbon Steel

**Finish:** Self-Colored, Hot Galvanized



Self-Colored Stock No.	Galvanized Stock No.	Nominal Shackle Size	Inside Length A	Inside Width		Diameter Pin D	Cotter Pin	Weight
				At Pin B	At Bow C			
SBC005300-0001	SBC005310-0001	5/16	1-1/16	1/2	1/2	5/16	1/16	0.19
SBC006300-0001	SBC006310-0001	3/8	1-1/4	5/8	5/8	7/16	1/8	0.31
SBC007300-0001	SBC007310-0001	7/16	1-7/16	3/4	3/4	1/2	1/8	0.44
SBC008300-0001	SBC008310-0001	1/2	1-5/8	13/16	13/16	5/8	1/8	0.80
SBC010300-0001	SBC010310-0001	5/8	1-15/16	1	1	3/4	1/8	1.52
SBC012300-0001	SBC012310-0001	3/4	2-5/16	1-1/4	1-1/4	7/8	3/16	2.36
SBC014300-0001	SBC014310-0001	7/8	2-3/4	1-7/16	1-7/16	1	3/16	3.78
SBC100300-0001	SBC100310-0001	1	3-1/8	1-5/8	1-5/8	1-1/16	3/16	5.17

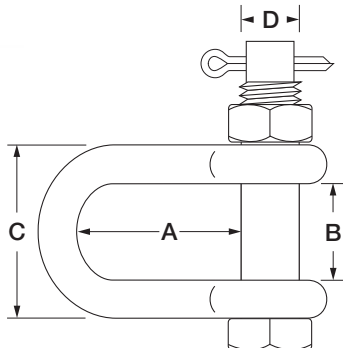

# CHAIN SHACKLES

## SCREW PIN

**Material:** Forged 1030 Carbon Steel  
**Finish:** Self-Colored, Hot Galvanized



Self-Colored Stock No.	Galvanized Stock No.	Nominal Shackle Size	Inside Length A	Inside Width		Diameter Pin D	Weight
				At Pin B	At Bow C		
SPC005300-0001	SPC005310-0001	5/16	1-1/16	1/2	1/2	5/16	.16
SPC006300-0001	SPC006310-0001	3/8	1-1/4	5/8	5/8	7/16	.27
SPC007300-0001	SPC007310-0001	7/16	1-7/16	3/4	3/4	1/2	.40
SPC008300-0001	SPC008310-0001	1/2	1-5/8	13/16	13/16	5/8	.67
SPC010300-0001	SPC010310-0001	5/8	1-15/16	1	1	3/4	1.38
SPC012300-0001	SPC012310-0001	3/4	2-5/16	1-1/4	1-1/4	7/8	2.23
SPC014300-0001	SPC014310-0001	7/8	2-3/4	1-7/16	1-7/16	1	3.35
SPC100300-0001	SPC100310-0001	1	3-1/8	1-5/8	1-5/8	1-1/16	4.71

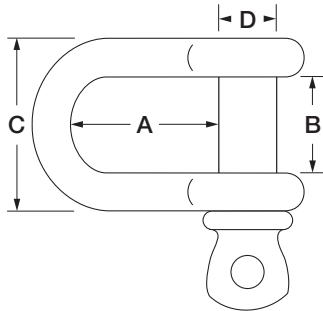

# CHAIN SHACKLES

## ROUND PIN

**Material:** Forged 1030 Carbon Steel  
**Finish:** Self-Colored, Hot Galvanized



Self-Colored Stock No.	Galvanized Stock No.	Nominal Shackle Size	Inside Length A	Inside Width		Diameter Pin D	Cotter Pin	Weight
				At Pin B	At Bow C			
RPC005300-0001	RPC005310-0001	5/16	1-1/16	1/2	1/2	5/16	1/16	0.16
RPC006300-0001	RPC006310-0001	3/8	1-1/4	5/8	5/8	7/16	1/8	0.28
RPC007300-0001	RPC007310-0001	7/16	1-7/16	3/4	3/4	1/2	1/8	0.42
RPC008300-0001	RPC008310-0001	1/2	1-5/8	13/16	13/16	5/8	1/8	0.73
RPC010300-0001	RPC010310-0001	5/8	1-15/16	1	1	3/4	1/8	1.42
RPC012300-0001	RPC012310-0001	3/4	2-5/16	1-1/4	1-1/4	7/8	3/16	2.19
RPC014300-0001	RPC014310-0001	7/8	2-3/4	1-7/16	1-7/16	1	3/16	3.31
RPC100300-0001	RPC100310-0001	1	3-1/8	1-5/8	1-5/8	1-1/16	3/16	4.76

