

CLEVISES

Material: C-1035, SA-182-F-11, Stainless Steel

Threads: U.N.C./U.N.F. Class 2 B, Right or Left Hand, Metric

Finish: Self-Colored, Galvanized, Plated, Electro-Polished

Options: Other Alloys, Heat Treating, Special Threading

Note: Pins Sold Separately - Straight or Headed

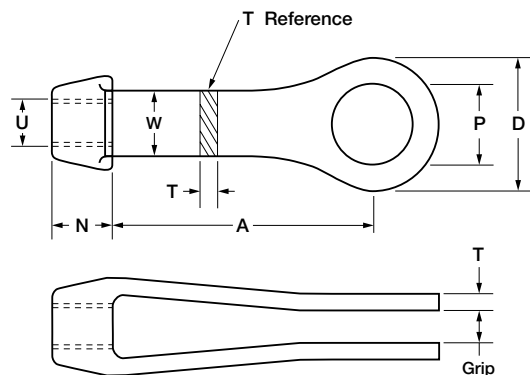

Table I: Standard Clevis Dimensions (Inches)

Part No.	Clevis No.	D	N	Thd. Max. U	W	T	A	Pin Max. P	Rated Capacity (Lbs.)	Unit Wt. (Lbs.)
CL20	2	1 7/16	5/8	5/8	1 1/16	5/16 + 1/32-0	3 9/16	3/4	3500	1
CL25	2 1/2	2 1/2	1	7/8	1 1/4	5/16 + 1/32-0	4	1 1/2	7500	2 1/2
CL30	3	3	1 1/4	1 3/8	1 1/2	1/2 + 1/16-1/32	5 1/16	1 3/4	15000	4
CL35	3 1/2	3 1/2	1 1/2	1 1/2	1 3/4	1/2 + 1/16-1/16	6	2	18000	6
CL40	4	4	1 3/4	1 3/4	2	1/2 + 1/16-1/16	5 15/16	2 1/4	21000	9
CL50	5	5	2 1/4	2 1/8	2 1/2	5/8 + 3/32-0	7	2 1/2	37500	16
CL60	6	6	2 3/4	2 1/2	3	3/4 + 3/32-0	8	3	54000	26
CL70	7	7	3	3	3 1/2	7/8 + 1/8-1/16	9	3 3/4	68500	36
CL80	8	8	4	4	4	1 1/2 + 1/8-1/16	10 1/8	4 1/4	135000	90

Maximum working loads have been established with a design factor of 5:1 using the maximum pin diameter, the resulting net area of the eye at the pin hole, and the expected ultimate tensile strength of C-1035 steel.

The maximum tap size (U dimension) shown in Table I, is for reference purposes only. It should be used only to determine the largest tap diameter the clevis may accommodate without considering the pin diameter. Use Table II to select the proper combination of tap size and pin diameter for any given size of clevis.

Clevis sizes for any given tap size and pin diameter combination are based upon the net area of the eye at the pin hole, being equal to or greater than 125% of the net area at the minor diameter of a round rod without upset ends, threaded Unified National Coarse Series.

For any combination of tap size and pin diameter shown, the pin in double shear will develop the strength

of the rod if both the rod and pin are made from steel having the same physical properties. The pin must be investigated for bending. If inadequate, a larger diameter pin must be selected.

If the pin is made from steel with physical properties lower in value than the steel used for the rod, the pin may not develop the strength of the rod and either shear or bend. A larger pin diameter would then be required.

Some combinations of tap size and pin diameter shown will not develop the maximum working load of the clevis shown in Table I.

Selection of the rod and pin, and the material specifications including the clevis size are the responsibility of the purchaser or user. Load required should not exceed the maximum working load values shown in Table I.