

CHAIN SHACKLES

SCREW PIN

Material: Forged 1030 Carbon Steel

Finish: Self-Colored, Hot Galvanized



Self-Colored Stock No.	Galvanized Stock No.	Nominal Shackle Size	Inside Length A	Inside Width		Diameter Pin D	Weight
				At Pin B	At Bow C		
SPC005300-0001	SPC005310-0001	5/16	1-1/16	1/2	1/2	5/16	.16
SPC006300-0001	SPC006310-0001	3/8	1-1/4	5/8	5/8	7/16	.27
SPC007300-0001	SPC007310-0001	7/16	1-7/16	3/4	3/4	1/2	.40
SPC008300-0001	SPC008310-0001	1/2	1-5/8	13/16	13/16	5/8	.67
SPC010300-0001	SPC010310-0001	5/8	1-15/16	1	1	3/4	1.38
SPC012300-0001	SPC012310-0001	3/4	2-5/16	1-1/4	1-1/4	7/8	2.23
SPC014300-0001	SPC014310-0001	7/8	2-3/4	1-7/16	1-7/16	1	3.35
SPC100300-0001	SPC100310-0001	1	3-1/8	1-5/8	1-5/8	1-1/16	4.71

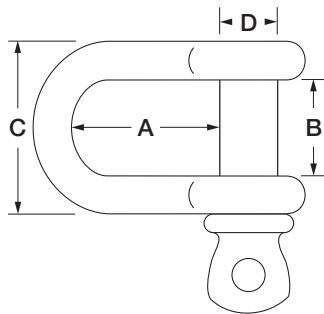

CHAIN SHACKLES

ROUND PIN

Material: Forged 1030 Carbon Steel

Finish: Self-Colored, Hot Galvanized



Self-Colored Stock No.	Galvanized Stock No.	Nominal Shackle Size	Inside Length A	Inside Width		Diameter Pin D	Cotter Pin	Weight
				At Pin B	At Bow C			
RPC005300-0001	RPC005310-0001	5/16	1-1/16	1/2	1/2	5/16	1/16	0.16
RPC006300-0001	RPC006310-0001	3/8	1-1/4	5/8	5/8	7/16	1/8	0.28
RPC007300-0001	RPC007310-0001	7/16	1-7/16	3/4	3/4	1/2	1/8	0.42
RPC008300-0001	RPC008310-0001	1/2	1-5/8	13/16	13/16	5/8	1/8	0.73
RPC010300-0001	RPC010310-0001	5/8	1-15/16	1	1	3/4	1/8	1.42
RPC012300-0001	RPC012310-0001	3/4	2-5/16	1-1/4	1-1/4	7/8	3/16	2.19
RPC014300-0001	RPC014310-0001	7/8	2-3/4	1-7/16	1-7/16	1	3/16	3.31
RPC100300-0001	RPC100310-0001	1	3-1/8	1-5/8	1-5/8	1-1/16	3/16	4.76

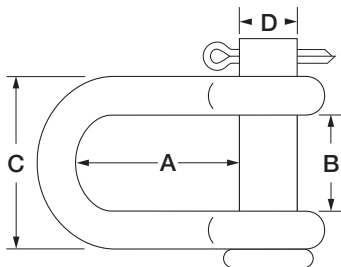

CHAIN SHACKLES

SAFETY BOLT

Material: Forged 1030 Carbon Steel

Finish: Self-Colored, Hot Galvanized



Self-Colored Stock No.	Galvanized Stock No.	Nominal Shackle Size	Inside Length A	Inside Width		Diameter Pin D	Cotter Pin	Weight
				At Pin B	At Bow C			
SBC005300-0001	SBC005310-0001	5/16	1-1/16	1/2	1/2	5/16	1/16	0.19
SBC006300-0001	SBC006310-0001	3/8	1-1/4	5/8	5/8	7/16	1/8	0.31
SBC007300-0001	SBC007310-0001	7/16	1-7/16	3/4	3/4	1/2	1/8	0.44
SBC008300-0001	SBC008310-0001	1/2	1-5/8	13/16	13/16	5/8	1/8	0.80
SBC010300-0001	SBC010310-0001	5/8	1-15/16	1	1	3/4	1/8	1.52
SBC012300-0001	SBC012310-0001	3/4	2-5/16	1-1/4	1-1/4	7/8	3/16	2.36
SBC014300-0001	SBC014310-0001	7/8	2-3/4	1-7/16	1-7/16	1	3/16	3.78
SBC100300-0001	SBC100310-0001	1	3-1/8	1-5/8	1-5/8	1-1/16	3/16	5.17

